

B-11-109  
Robt. Clark &  
Saml. Barton

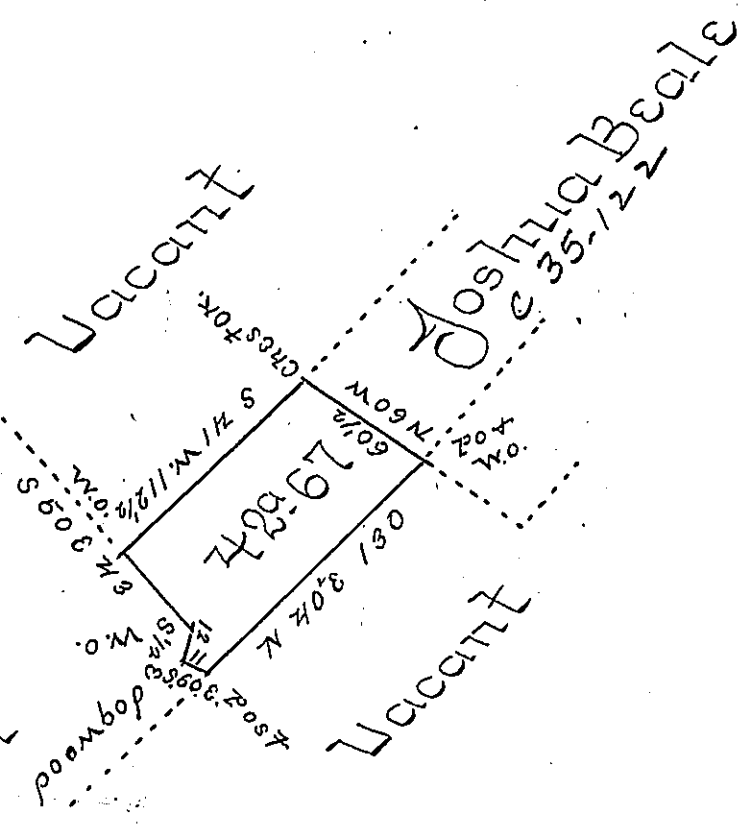

Draught of forty two acres and sixty seven perches of land with 6<sup>th</sup> Cent for roads situate in Back Township in Mifflin county surveyed 2<sup>nd</sup> June 1808 in pursuance of a Warrant to David Beale dated 25<sup>th</sup> January 1805

James Harris D.S.

Samuel Cochran Esquire  
Surveyor General  
of Pennsylvania

*IN TESTIMONY* that the above is a copy of the original remaining on file in the Department of Internal Affairs of Pennsylvania, made conformably to an Act of Assembly approved the 16th day of February, 1833, I have hereunto set my Hand and caused the Seal of said Department to be affixed at Harrisburg, this first day of December 1903.

*James R. Brown*  
Secretary of Internal Affairs.